

ELECTRICAL READOUT PANELS

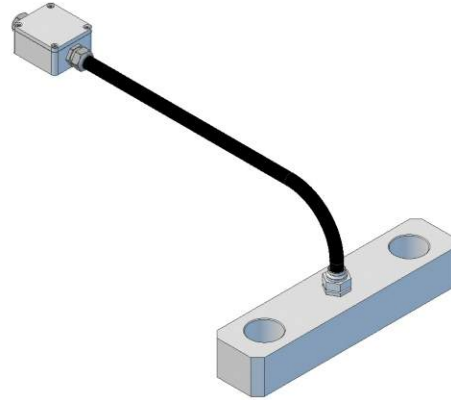

GENERAL INFORMATION

The Readout Panel works in conjunction with the Tension Load cell to provide a Digital Readout of the Tension.

This unit can be supplied in various supply power options:

- 110 VAC
- 220 VAC
- 12 VDC
- 24 VDC

ADVANTAGES

- 12VDC Unit is Self Powered by Battery.
- Spring Return Selector avoids discharge if not in use.
- Accurate reading compared to Mechanical Tension Meters due to calibrated Load cell and Digital Readout.
- Can be integrated into any standard panel.

SYSTEM INCLUSIONS

- I.P. 65 Enclosure.
- Digital Readout.
- Spring Return Selector.